

PANORAMA ANTENNAS

This antenna can be provided with suitable extension coaxial cables as a 'plug & play' kit for all TETRA terminals.

GPSK-TET Shown

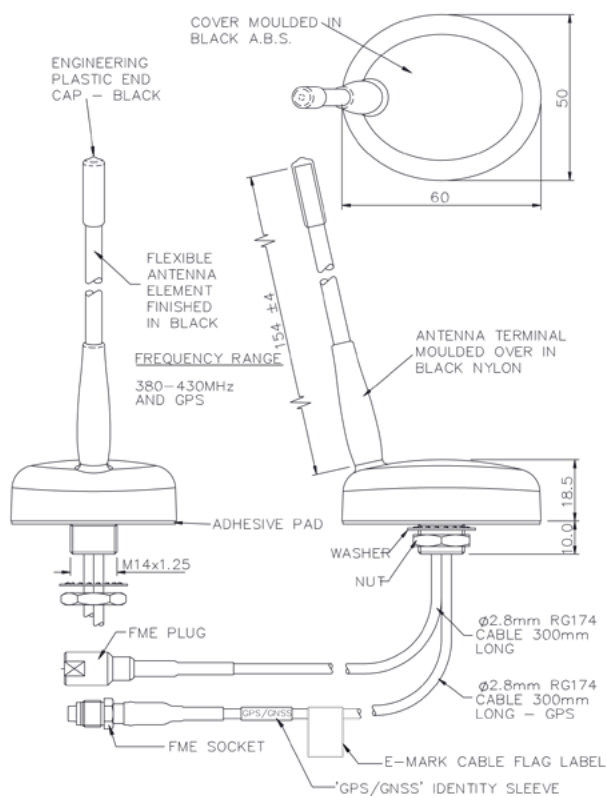

GPS/GNSS Combination Antenna

PANORAMA ANTENNAS

GPSK-TET

Product Data

Part No.

GPSK-TET

Electrical Data

Frequency Range (MHz)	380-430
Gain: Isotropic	2dBi
Compared to 1/4 wave	0dB
Polarisation	Vertical
Pattern	Omni-directional
Impedance	50Ω
Max Input Power (W)	25

GPS Data

Frequency Range (MHz)	1559 - 1612
VSWR	<2.5:1
Gain: LNA	30dB
Polarisation	Right Hand Circular
Operating Voltage	3 - 5V DC (fed via coax)
Current	Typical <20mA

Mechanical Data

Whip Length	154 (6")
Base Height	18.5 (0.73")
Base Length	60 (2.4")
Base Width	50 (1.96")
Operating Temp (°C)	-40° / +80°C (-40° / +176°F)
Colour	Black

Mounting Data

Fixing / Hole Size (mm)	Panel Mount / 15 (0.6")
-------------------------	-------------------------

Cable Data	GPS/GNSS Cable	Comms Cable
Type	RG174	
Diameter (mm)	2.8 (0.1")	
Length (m)	0.3 (11.8")	
Termination	FME socket (f)	FME plug (m)

Typical VSWR*

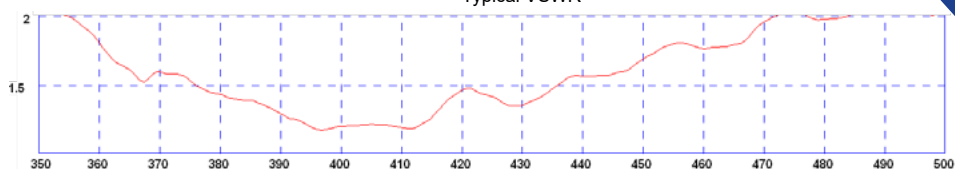

* Measured on a 600 x 600mm (2' x 2') groundplane with 5m (16') of CS23 cable.

Typical E-Plane (390MHz)

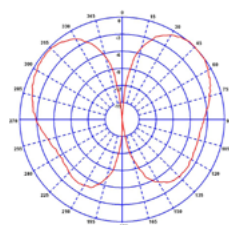

Typical H-Plane (390MHz)

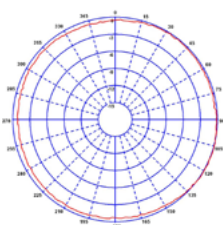

Typical E Plane (GPS 1575MHz)

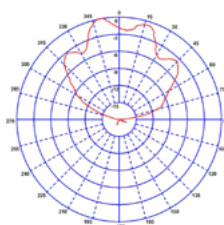

Electrical Data